



Copper Tube Terminals



Our copper tube terminals are manufactured from seamless copper tube to BS2871/C106

All terminals are provided with an inspection hole to ensure that the cable has been fully inserted into the terminal prior to crimping.

A bell mouth helps to prevent chafing in instances where the assembly may be subject to vibration.

All Crimp 'n' Fix terminals fully comply with BS EN 61238-1-2003

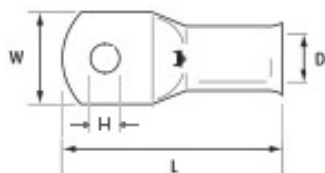

Crimp 'n' Fix Pt.No.	Cable size mm ²	Hole Size H	Width W	Length L	Inside Dia D	Tab Thickness
CCT211005	10	5.1	10.4	30	4.5	1.7
CCT211006	10	6.3	10.6	30	4.5	1.7
CCT211008	10	8.2	12.5	30	4.5	1.2
CCT211010	10	10.4	14.7	34.1	4.5	1.5
CCT211012	10	12.7	17.5	34.1	4.5	1.2
CCT211606	16	6.3	11	30.7	5.5	2.0
CCT211608	16	8.3	12.5	30.7	5.5	1.6
CCT211610	16	10.3	15.1	35.9	5.5	1.5
CCT211612	16	12.8	17.5	35.9	5.5	1.3
CCT212506	25	6.3	13.1	32.2	8.6	2.4
CCT212508	25	8.3	13.1	32.2	8.6	2.4
CCT212510	25	10.2	15.1	36.9	8.6	2.1
CCT212512	25	12.8	17.5	36.9	8.6	1.9
CCT213506	35	6.3	15.8	37.6	8.6	2.4
CCT213508	35	8.3	15.8	37.6	8.6	2.4
CCT213510	35	10.3	16.2	41.5	8.6	2.4
CCT213512	35	12.9	18.6	41.5	8.6	2.2
CCT215006	50	6.3	17.6	40.2	9.6	2.5
CCT215008	50	8.3	17.6	40.2	9.6	2.5
CCT215010	50	10.3	17.6	43.2	9.6	2.5
CCT215012	50	12.8	18.7	43.2	9.6	2.5
CCT217006	70	6.3	21.8	50.4	12	3.0
CCT217008	70	8.2	21.8	50.4	12	3.0
CCT217010	70	10.2	21.8	50.4	12	3.0
CCT217012	70	12.7	21.8	50.4	12	3.0
CCT217014	70	14.8	22.2	52.9	12	3.0
CCT217016	70	16.3	22.2	52.9	12	3.0
CCT219508	95	8.3	24.3	53.2	13.5	3.2
CCT219510	95	10.3	24.3	53.2	13.5	3.2
CCT219512	95	12.7	24.3	53.2	13.5	3.2
CCT219514	95	14.8	24.3	56.8	13.5	3.2
CCT219516	95	16.3	24.3	56.8	13.5	3.2